



Portable seamclosing pliers MVZ 11 · MVZ 15 · MVZ 17



Portable seamclosing pliers

- part of the Eckold seamclosing system
- used mainly in the automotive industry to produce add-on parts for cars



Drive



Range of application

- doors
- engine bonnets
- tailgate
- roof apertures
- side panels / wheel housing
- wing

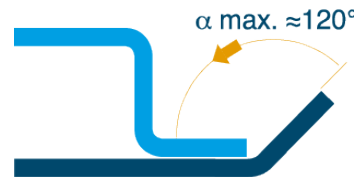
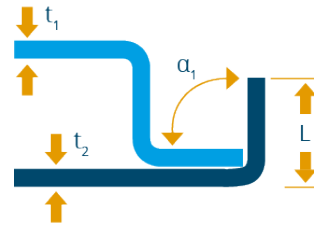

	min.	max.
t	~ 0.5 mm	~ 1.5 mm
L	~ 5.0 mm	~ 13.0 mm
α_1		105°

MVZ 11

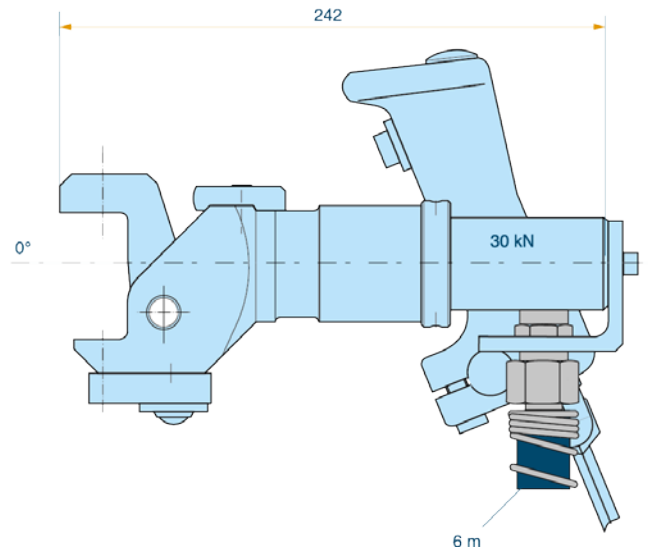

Type of pliers

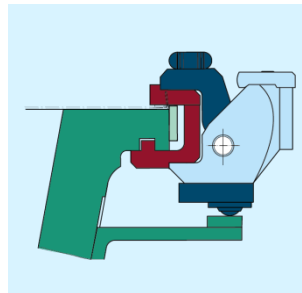
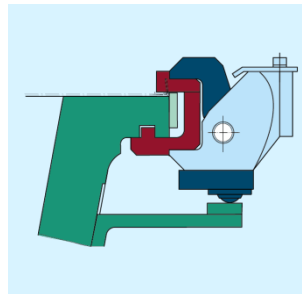
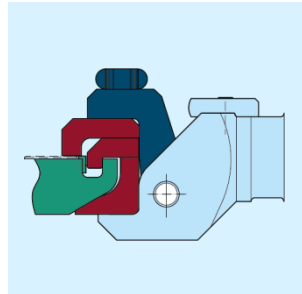

Throat

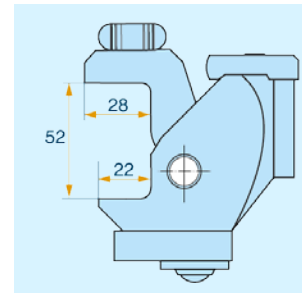
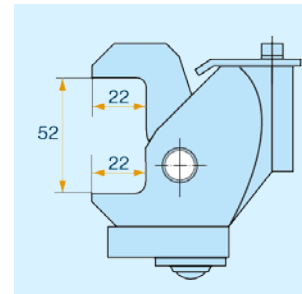
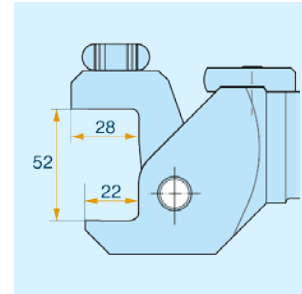

Insert mounting

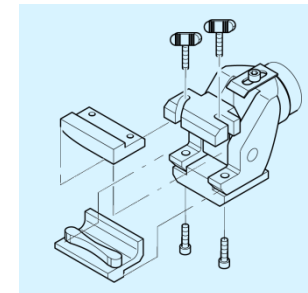
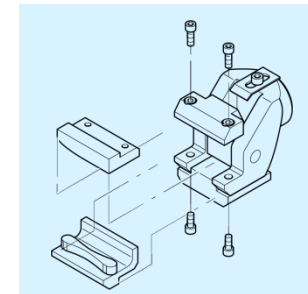
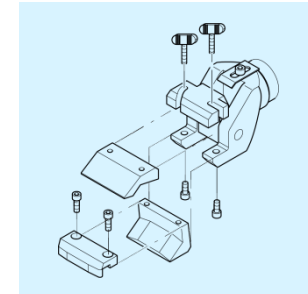

MVZ 11/007

MVZ 11/003

MVZ 11/008

MVZ 15

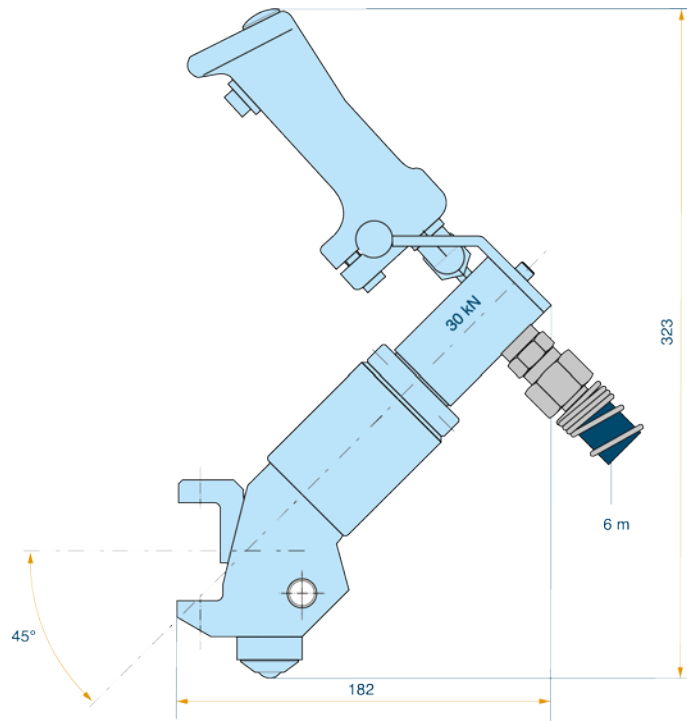

Type of pliers

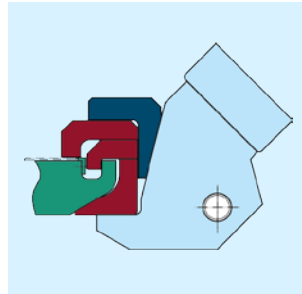

Throat

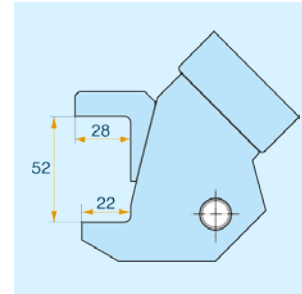

Insert mounting

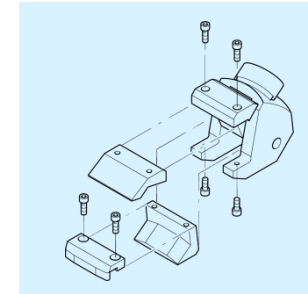

MVZ 15/007

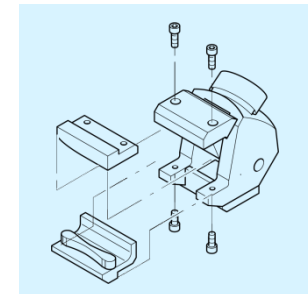
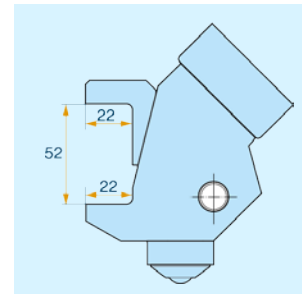
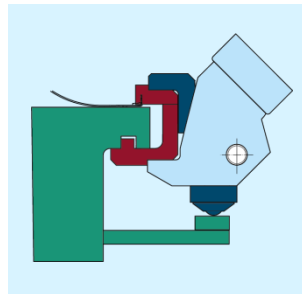

MVZ 15/008

MVZ 17

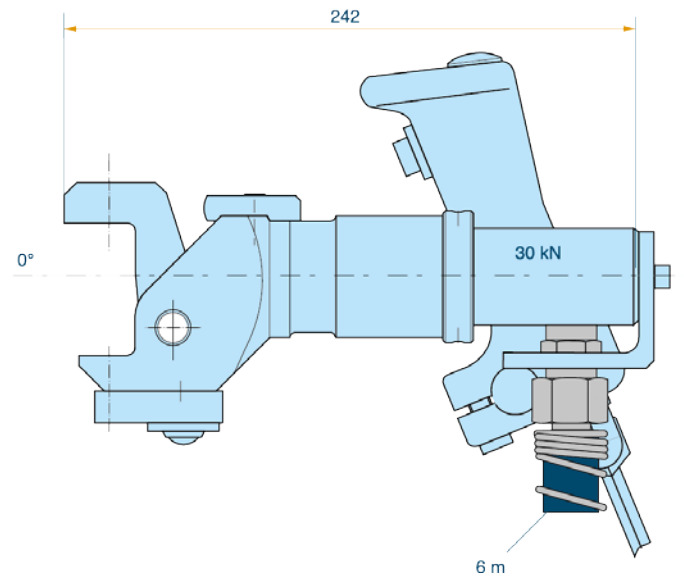

Type of pliers

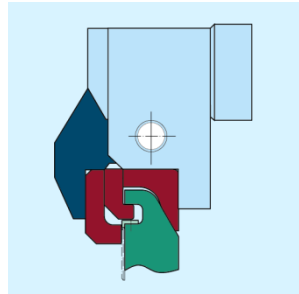

Throat

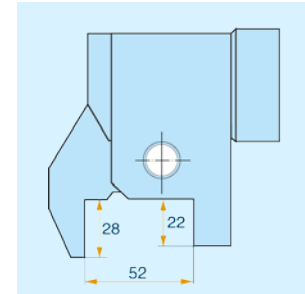

Insert mounting

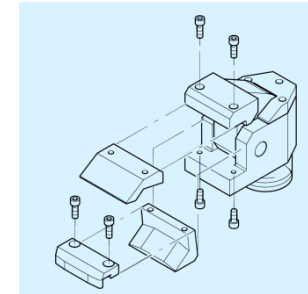

MVZ 17/007

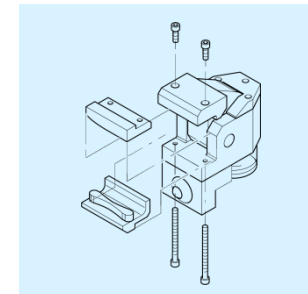
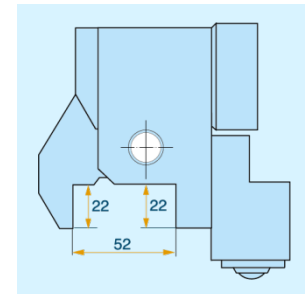
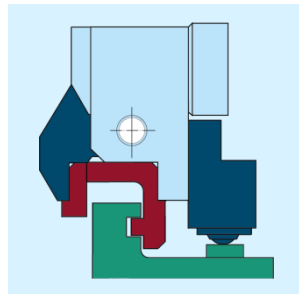

MVZ 17/008

Portable pliers in operation

MVZ 11/007



Seamclosing pliers type 007 with inserts for guiding groove on top of fixture rim



Seamclosing pliers type 003 / 008 with inserts for guiding groove under fixture rim



Notice

- Seamclosing fixtures are no longer offered by Eckold.
- Parameters of the pliers and inserts can be provided to the customer in case of an order for an in-house production.
- Seamclosing segments are offered on demand.

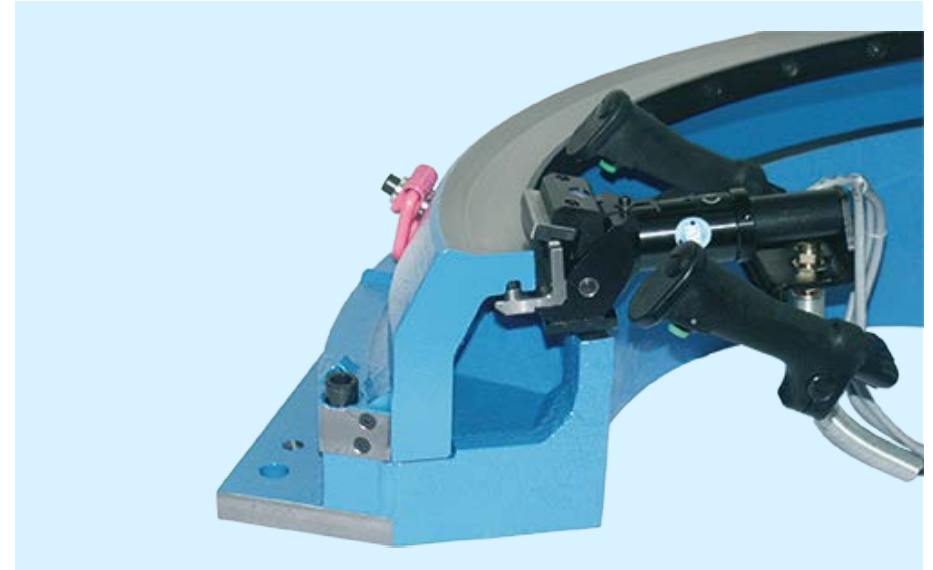

Seamclosing segment wheel house

Examples for application

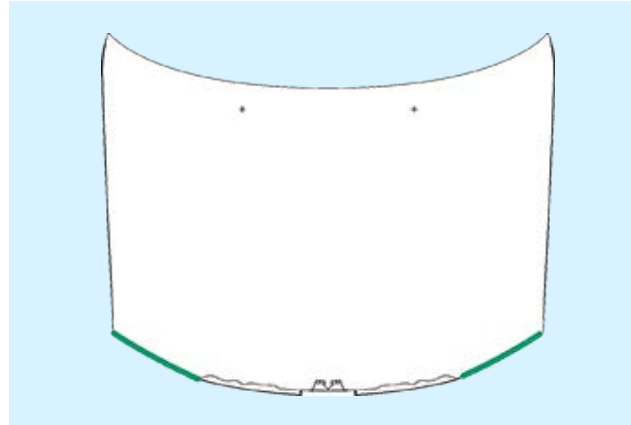
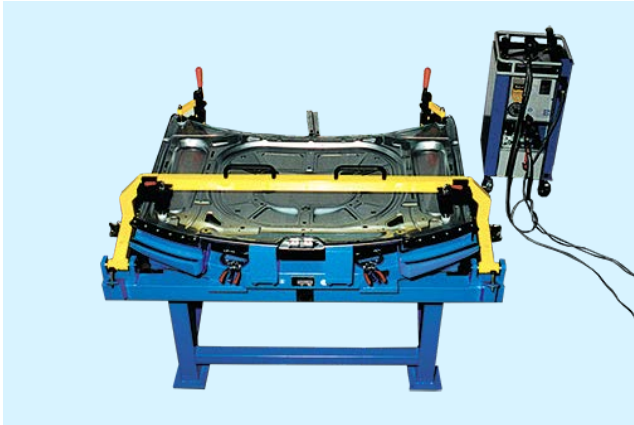

engine bonnet

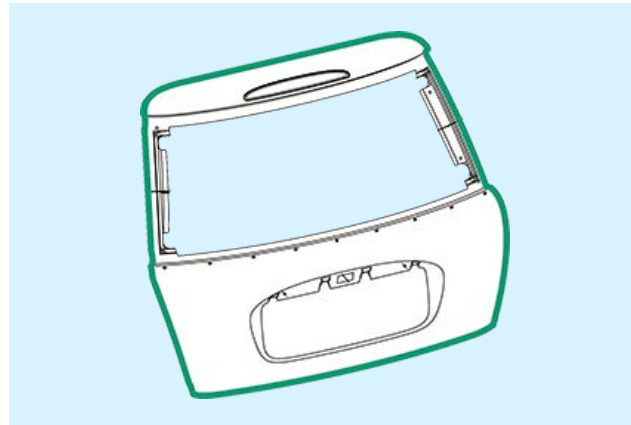
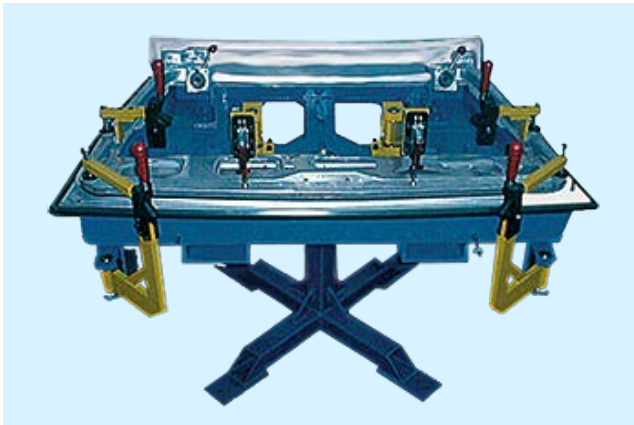

tailgate

Examples for application

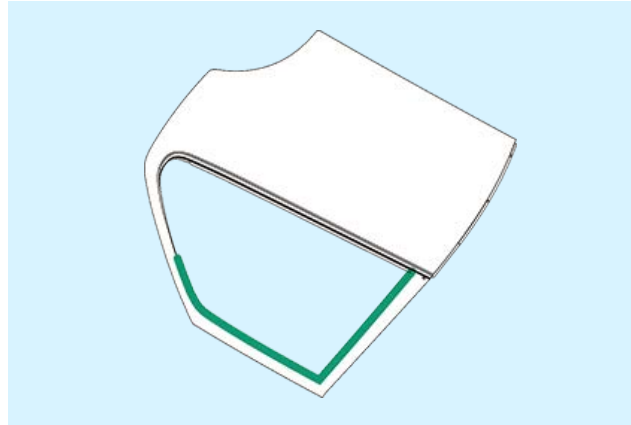
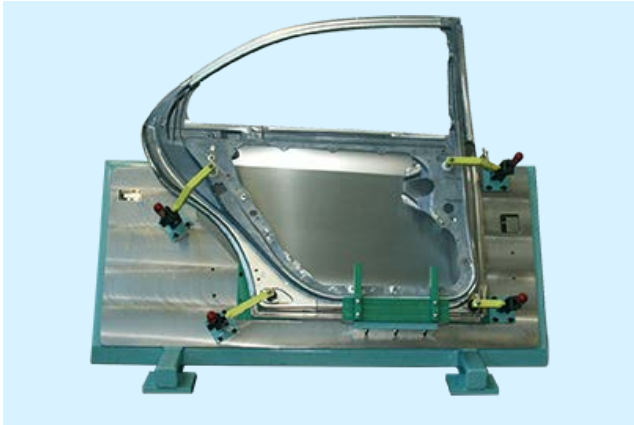

rear door

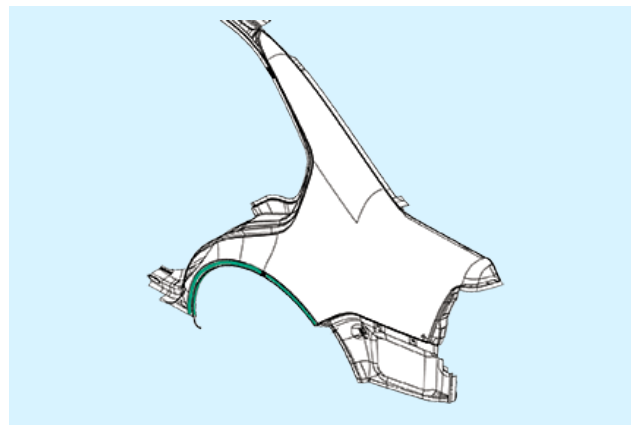
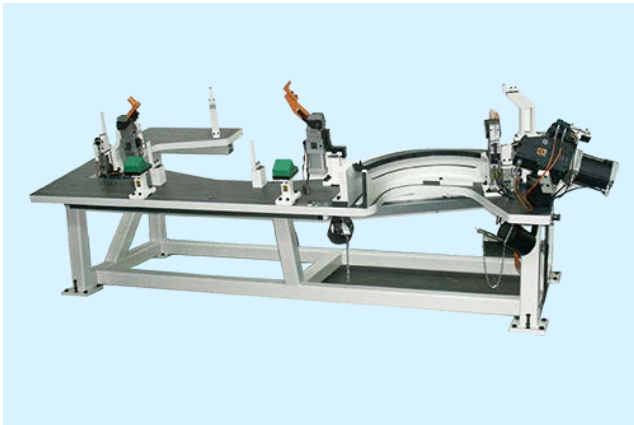

side panel with
wheel house

Examples for application



roof apertures

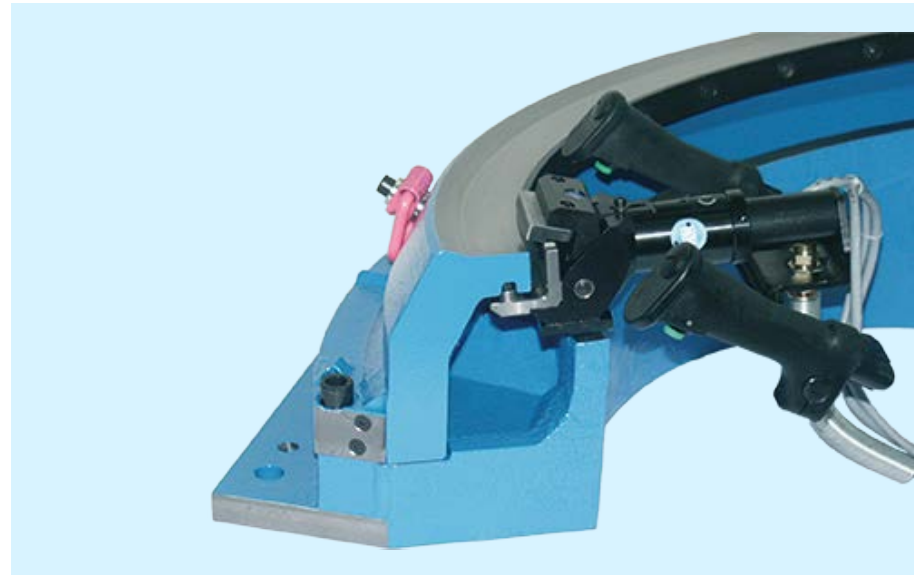

segment wheel house

Target sectors





DISTRIBUTEUR EXCLUSIF EN FRANCE, ALGERIE, MAROC ET TUNISIE POUR :



6 Allée des Carrières
Z.A.E Des Portes de la Fôret
F-77090 COLLEGIEN

Tél. : +33 (0) 1 64 30 92 47
Fax : +33 (0) 1 64 30 81 92
Email : info@eckotech.fr
Site internet : www.eckotech.fr

SARL au capital de 100 000 €
SIRET : 350 241 378 00016
Code APE : 4662Z - N° EORI : FR35024137800016
N° d'identification européenne : FR 67 350 241 378

**Thank you
for your attention.**

www.eckotech.fr