

FLOW FORMING OF WHEELS



LEIFELD METAL SPINNING AG

Long Term and Trustful Cooperation

- ▶ The confidentiality of our clients plans and data is most critical. Leifeld rigorously applies organizational separation of teams working for competitors as well as several other rules **to protect the confidentiality of all client information.**
- ▶ Similarly, our industry is very competitive and we regard our approaches and insights as proprietary. Therefore, we look to our clients **to protect Leifelds interests in our presentations, methodologies and techniques. Under no circumstances** should this material be shared with any third party, including competitors, **without the written consent of Leifeld Metal Spinning.**



THE ST..RS SERIES

High-Power Precision Flow Forming

BENEFITS

- ▶ Cost-efficient manufacturing
- ▶ Reliable production process
- ▶ Shortest cycle times
- ▶ High degree of material utilization
- ▶ High service life
- ▶ Low maintenance costs
- ▶ Special compact guides
- ▶ Production of wheel discs
- ▶ Production of resource-saving rim rings with straight roller bearing



THE ST..RS SERIES

Flow Forming with Power and Precision

BENEFITS

- ▶ Highest stability due to closed machine frame
- ▶ Bronze guide-ways for radial axes
- ▶ Oversized linear guides for axial axis
- ▶ Absolute measuring systems (ENC)
- ▶ Telescope steel covers for protection of guides and ball screws
- ▶ Automat. central lubrication (grease) for all guideways and ball screws
- ▶ Protective steel cover against dust and cooling water

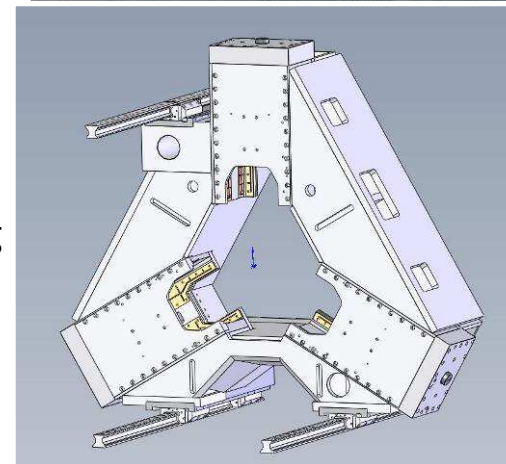

THE ST..RS SERIES

Flow Forming with Power and Precision

LONG MACHINE LIFE-TIME DUE TO...

- ▶ ... very stable and rigid frame-design machine construction
- ▶ ... high effective direction of forming forces towards the spindle due to the use of $3 \times 120^\circ$ support
- ▶ ... circulating oil lubrication to all bearings under fast revolution

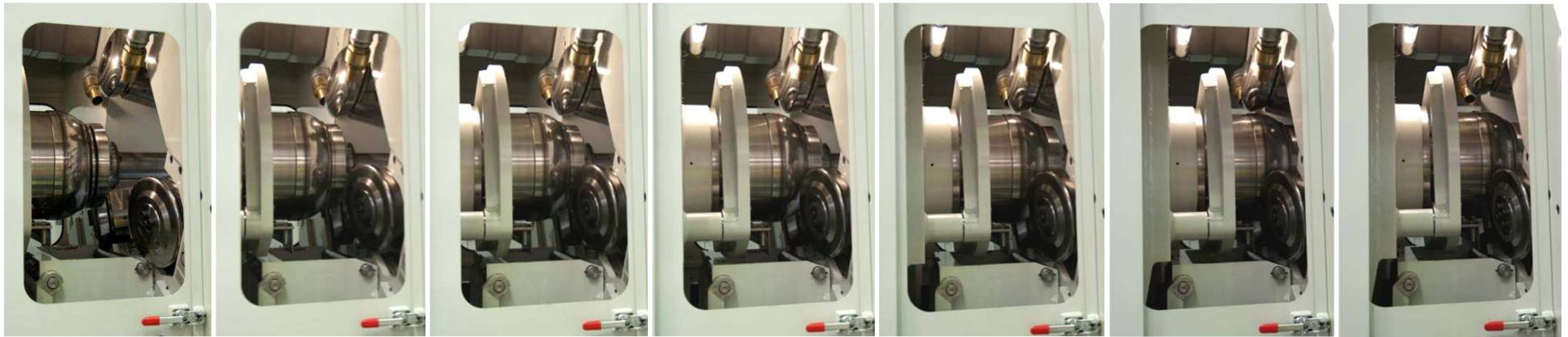

THE ST..RS SERIES

High-Power Precision Flow Forming

BENEFITS

- ▶ Hydraulic cylinder
 - ▶ Extreme high durability
 - ▶ High precision of axial axes
- ▶ Energy-efficient motors (savings potential 10%)
- ▶ Optimized loading and unloading unit
- ▶ Accessibility of main spindle of the working area
- ▶ 3 forming rollers
 - ▶ Higher roller life time
 - ▶ Symmetrical division of forces
 - ▶ High-precision rotation



THE ST..RS SERIES

High-Power Precision Flow Forming

	ST 600 H 600 (RS)	ST 650 H 900 (RS)
Outer diameter (max)	650 (700) mm	700 (700) mm
Outer diameter (min)	400 (350) mm	350 (300) mm
Disc height	250 mm	250 (400) mm
Axial force (max)	800 kN	800 kN
Radial force (max)	500 kN	500 kN
Main spindle power	265 kW	265 kW
Tailstock drive	-	89 kW



ST..RS MACHINES – ST 650 H 900



THE ST..RS SERIES

Machine ST 650 H 900 (RS)



THE ST..RS SERIES

Detail View



YOUR CONTACT TO LEIFELD METAL SPINNING AG



DISTRIBUTEUR EXCLUSIF EN FRANCE, ALGERIE, MAROC ET TUNISIE POUR :



6 Allée des Carrières
Z.A.E Des Portes de la Forêt
F-77090 COLLEGIEN

Tél. : +33 (0) 1 64 30 92 47
Fax : +33 (0) 1 64 30 81 92
Email : info@eckotech.fr
Site internet : www.eckotech.fr

SARL au capital de 100 000 €
SIRET : 350 241 378 00016
Code APE : 4662Z - N° EORI : FR35024137800016
N° d'identification européenne : FR 67 350 241 378